

for GearBoss® X-Cart™ and Team Cart™  
 (Cart End Closures, Tall and Short Attic End Closures)

**Basic Instructions only!**  
 For more detailed product information, refer to the  
 GearBoss High-Density Storage System Owner's Manual 240A099.

**⚠ CAUTION**

*Make sure anyone assembling, installing or using this product has read and understands these instructions.*

**⚠ CAUTION**

*Failure to comply with Warnings and Cautions in this document or on the equipment can result in damage to property or serious injury.*

**⚠ CAUTION**

*To help avoid damage and injury, more than one person is needed for installation.*

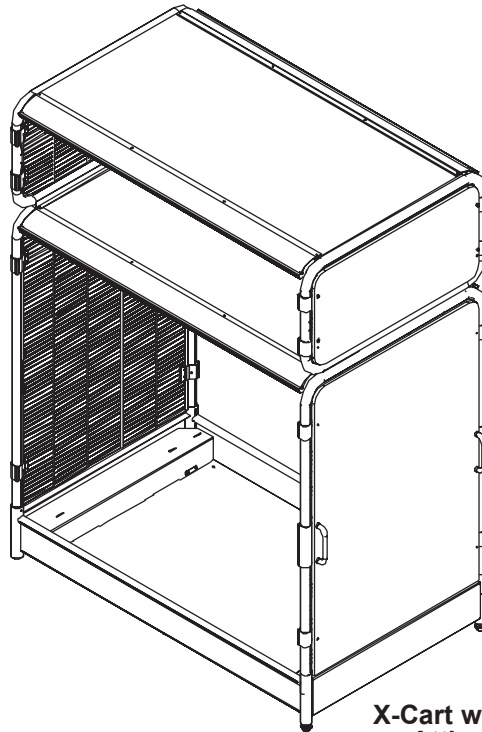

**X-Cart with End Closure and  
 Attic with End Closure**

## Contents

Required Tools .....	2	Cart End Closure Installation .....	4
Supplied Hardware .....	2	Attic End Closure Installation .....	9
Parts List .....	3	Replacement Parts .....	11



Visit the GearBoss High-Density Storage System web page at [gearboss.com](http://gearboss.com) for more information.

**Note:** Please read and understand these instructions before proceeding.  
**Note:** If you need additional information, contact Wenger Corporation using the information below.

# Required Tools

---

- Cordless drill
- 9/16" Combination wrench

# Supplied Hardware

---

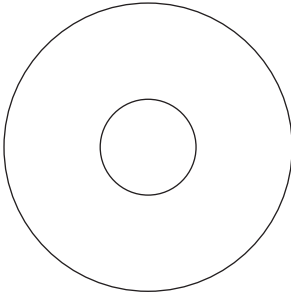

1/2"  
Self-adhesive Washer

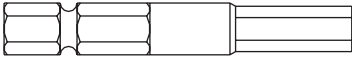

7/32"  
Hex Insert Bit

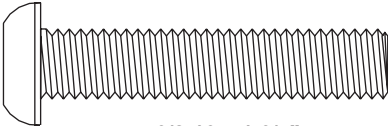

3/8-16 x 1-3/4"  
Button Head Screw

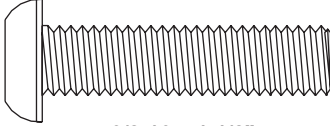

3/8-16 x 1-1/2"  
Button Head Screw



Dome  
Plug

# Parts List

## Attic End Closure Parts List and Hardware List

Item	Qty	Description
1	1	Attic End Closure
2	4	3/8-16 x 1-1/2" Button Head Screw**
3	4	1/2" Self-adhesive Washer
4	1	7/32" Hex Insert Bit**
**Not shown, refer to Supplied Hardware		

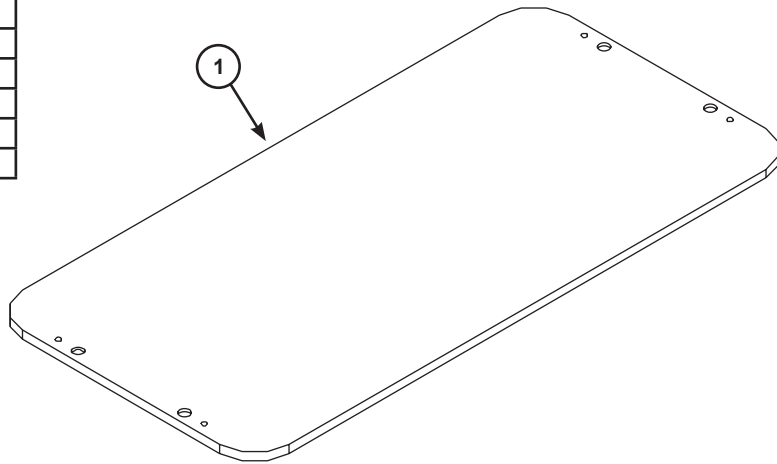

## Cart End Closure Parts List and Hardware List

Item	Qty	Description
1	1	Cart End Closure
2	4	3/8-16 x 1-1/2" Button Head Screw**
3	4	3/8-16 x 1-3/4" Button Head Screw**
4	4	Dome Plug**
5	8	1/2" Self-adhesive Washer**
6	1	7/32" Hex Insert Bit**
**Not shown, refer to Supplied Hardware		

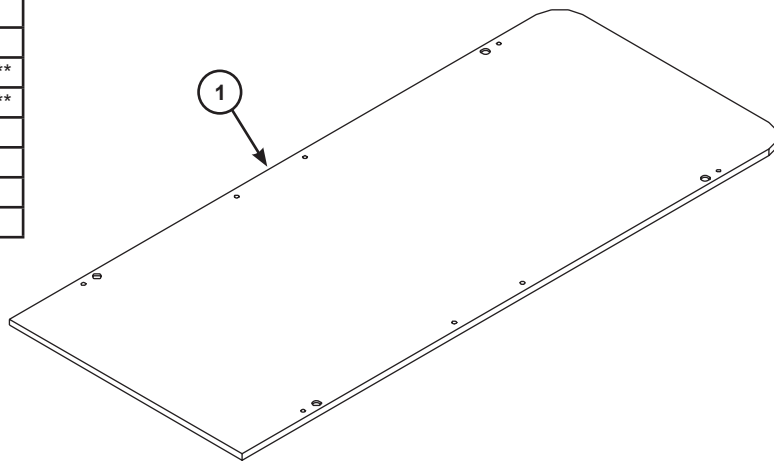

# Cart End Closure Installation

## NOTICE

The following installation instructions are the same for the 32" (813 mm) and 48" (1219 mm) carts.

## NOTICE

It may be necessary to use a step stool to reach the top.

## CAUTION

Never stand on the cart.

### Before Starting the Cart End Closure Installation

1. Move the cart end closure carton to the work area.
2. Open the carton and inventory the contents. Make sure that all of the required items listed in the Parts Lists are present including the hardware items. Discard the packing materials and corrugated carton.

## NOTICE

Not all hardware items packed in the carton may be needed. When the assembly is complete, discard any hardware items not used.

### Attach the Cart End Closure to the Front End Frame

1. Place the cart end closure onto the work surface with the 7/8" diameter countersink holes facing upward.
2. Attach the eight washers to the cart end closure.
  - a. Remove the protective liner from the pressure sensitive adhesive.
  - b. Press the washer surface with the pressure sensitive adhesive against the cart end closure surface centering each washer with the 1/2" diameter through hole.

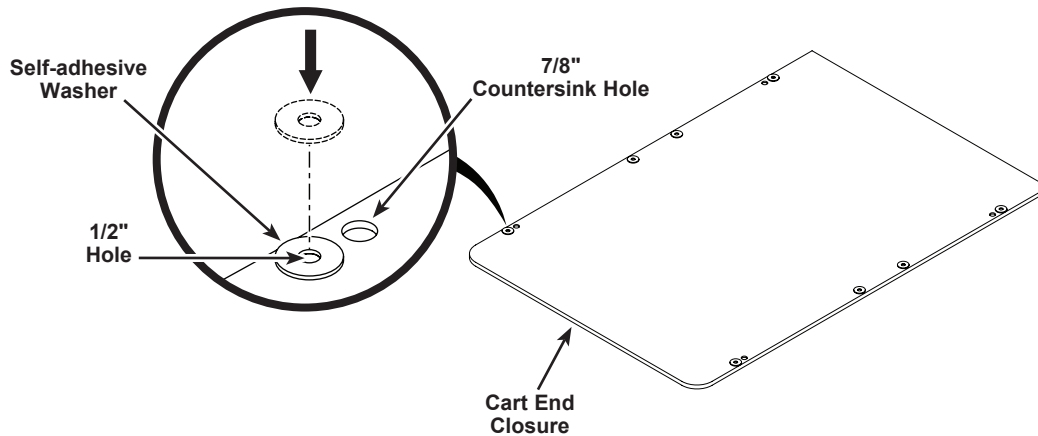

## ***Cart End Closure Installation (continued)***

3. Using a cordless drill and a 7/32" hex bit insert with a 9/16" combination wrench, remove the **upper** button head screw and acorn nut from each of the two **upper** front end panel brackets on the front end frame. Save the acorn nuts and discard the button head screws.
4. Remove the four button head screws from the two handle brackets. Set the two handles aside and discard the button head screws.
5. Remove the **lower** button head screw and acorn nut from each of the two **lower** front end panel brackets on the front end frame. Save the acorn nuts and discard the button head screws.

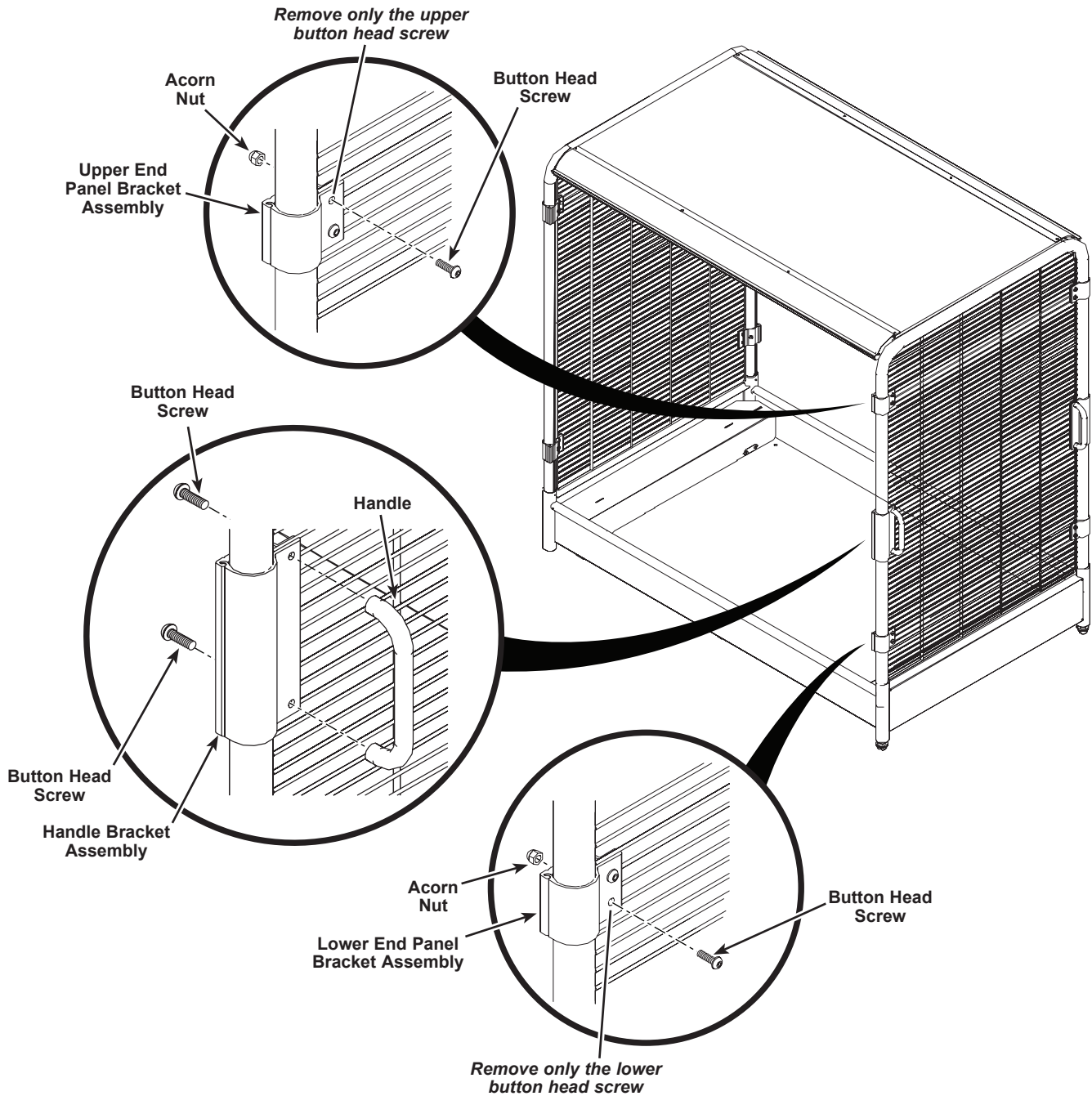

## ***Cart End Closure Installation (continued)***

6. Hold the cart end closure against the outer panel brackets.
  - a. Make sure that the washers applied in step 2 face the front end frame.
  - b. Align the holes in the cart end closure to the holes in the outer brackets.

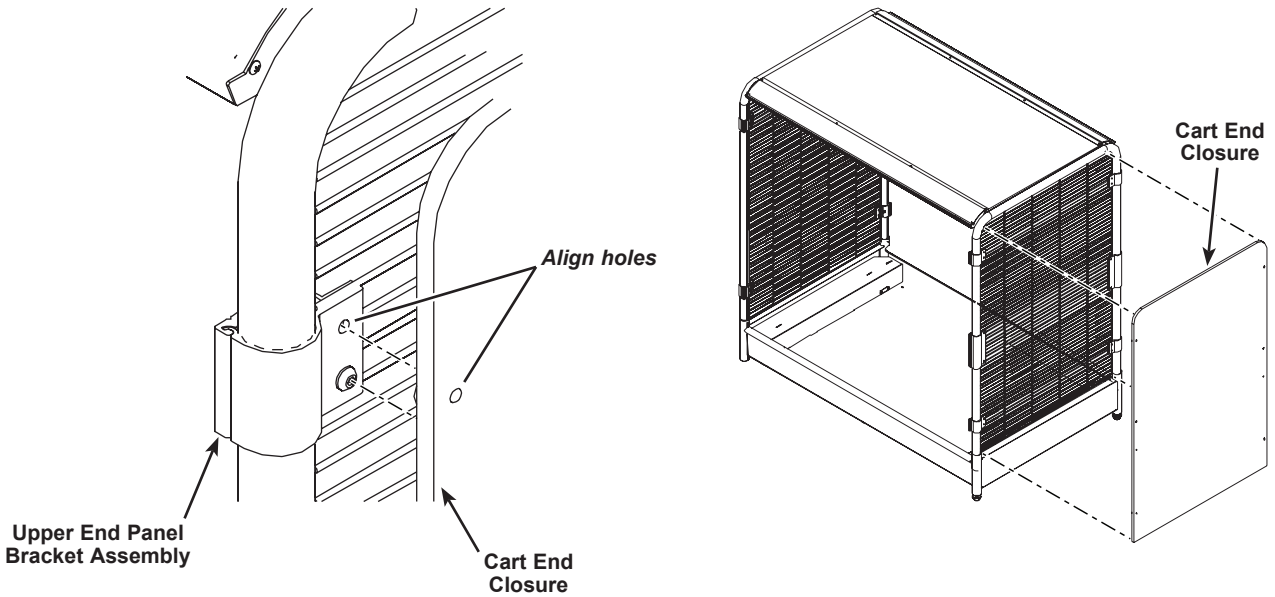

7. Attach the cart end closure to the front end frame as follows.
  - a. Attach four 3/8-16 x 1-1/2" button head screws and the four acorn nuts set aside in steps 3 and 5 as shown at the right.
  - b. Attach four 3/8-16 x 1-3/4" button head screws and two handles set aside in step 4 as shown at the right.

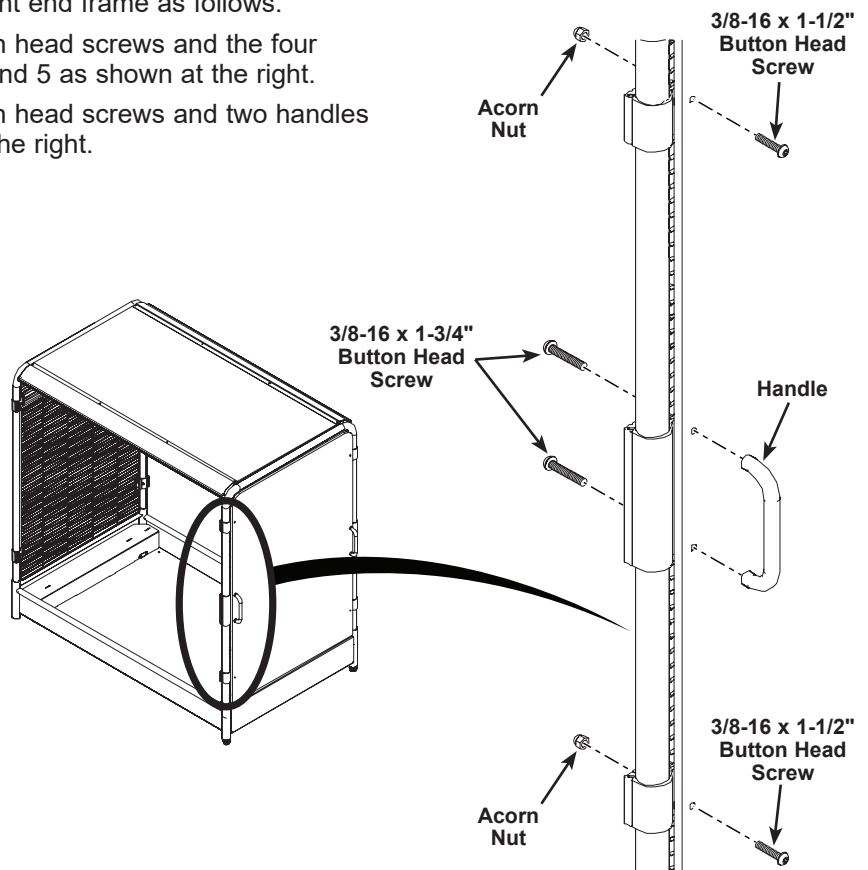

## Cart End Closure Installation (continued)

### Attach the Cart End Closure to the Rear End Frame

1. Place the cart end closure onto the work surface with the 7/8" diameter countersink holes facing upward.
2. Attach four washers to the cart end closure.
  - a. Remove the protective liner from the pressure sensitive adhesive.
  - b. Press the washer surface with the pressure sensitive adhesive against the cart end closure surface centering the washer with the two top and two bottom 1/2" diameter holes in the end panel as shown.

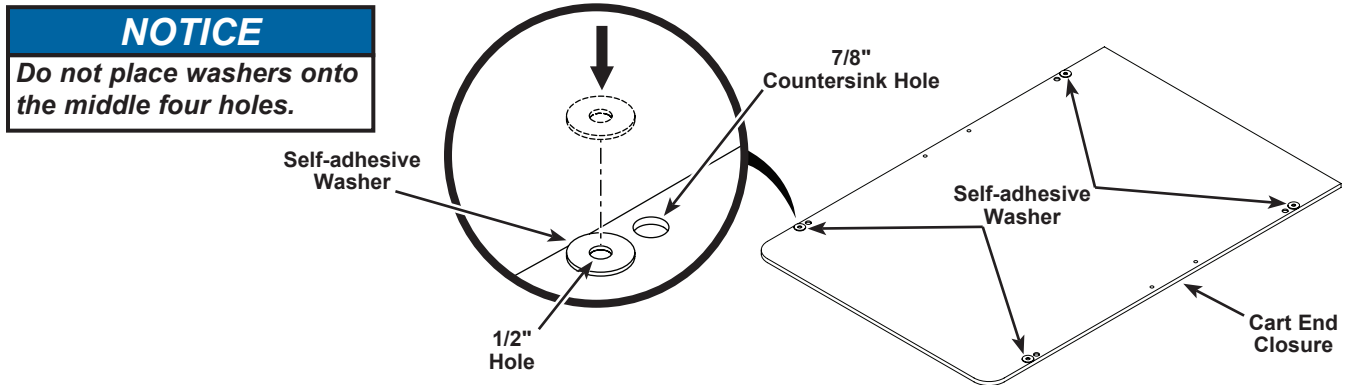

3. Using a cordless drill and a 7/32" hex bit insert with a 9/16" combination wrench, remove the **upper** button head screw and acorn nut from each of the two **upper** front end panel brackets on the front end frame. Save the acorn nuts and discard the button head screws.
4. Remove the **lower** button head screw and acorn nut from each of the two **lower** front end panel brackets on the front end frame. Save the acorn nuts and discard the button head screws.

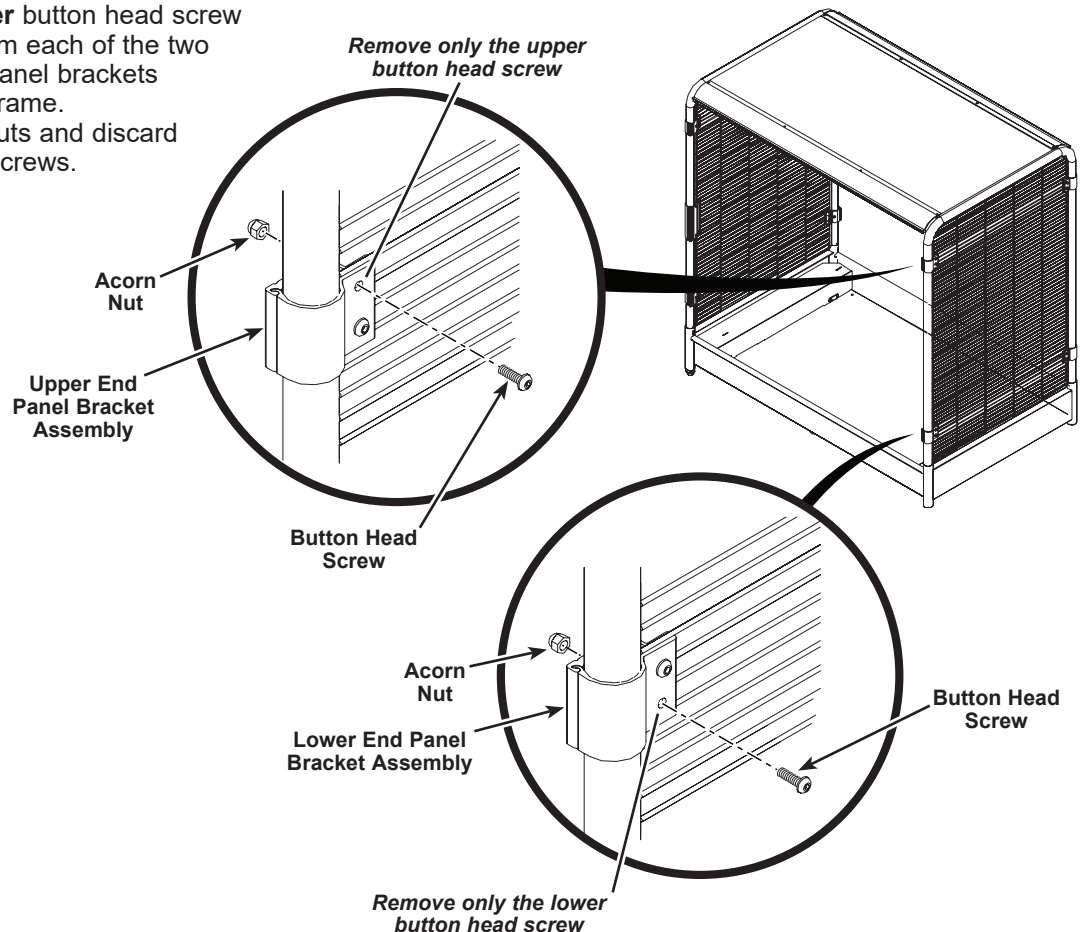

## ***Cart End Closure Installation (continued)***

---

5. Place the cart end closure against the rear frame outer panel brackets.
  - a. Make sure that the washers applied in step 2 face the rear end frame.
  - b. Align the holes in the cart end closure to the holes in the outer brackets.
6. Attach the cart end closure to the rear end frame as follows.
  - a. Using a cordless drill and a 7/32" hex bit insert with a 9/16" combination wrench, attach four 3/8-16 x 1-1/2" button head screws and the four acorn nuts (set aside in steps 3 and 4) as shown at the right.
  - b. Press four dome plugs into the four cart end closure middle clearance holes as shown below.

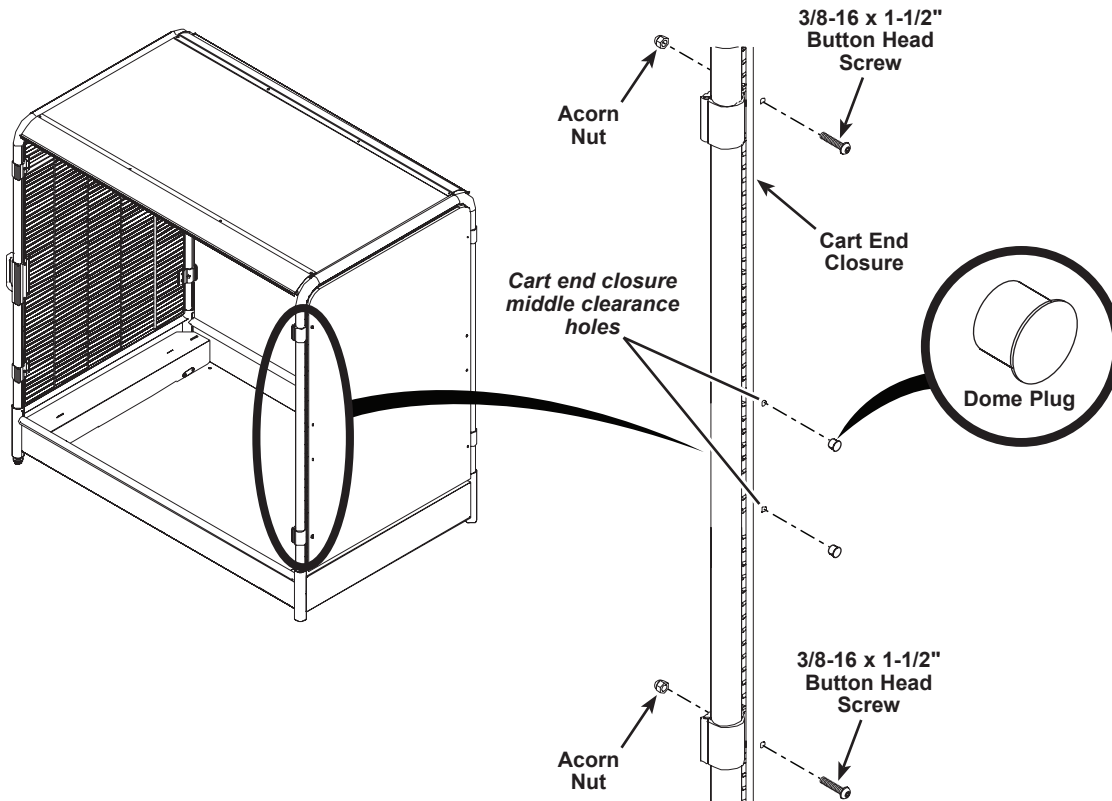



# Attic End Closure Installation

## NOTICE

The following installation instructions are the same for the tall or short attic end closure accessory assembled to a 48" (1219 mm) X-Cart.

## NOTICE

It may be necessary to use a step stool to reach the top.

## CAUTION

Never stand on the cart.

### Before Starting the Attic End Closure Installation

1. Move the attic end closure carton to the work area.
2. Open the carton and inventory the contents. Make sure that all of the required items listed in the Parts Lists are present including the hardware items. Discard the packing materials and corrugated carton.

## NOTICE

Not all hardware items packed in the carton may be needed. When the assembly is complete, discard any hardware items not used.

### Attach the Attic End Closure to the Attic End Frame

1. Place the attic end closure onto the work surface with the 7/8" diameter countersink holes facing upward.
2. Attach four washers to the attic end closure.
  - a. Remove the protective liner from the pressure sensitive adhesive on the washer.
  - b. Press the washer surface with the pressure sensitive adhesive against the attic end closure surface centering the washer inside diameter with the 1/2" diameter hole.

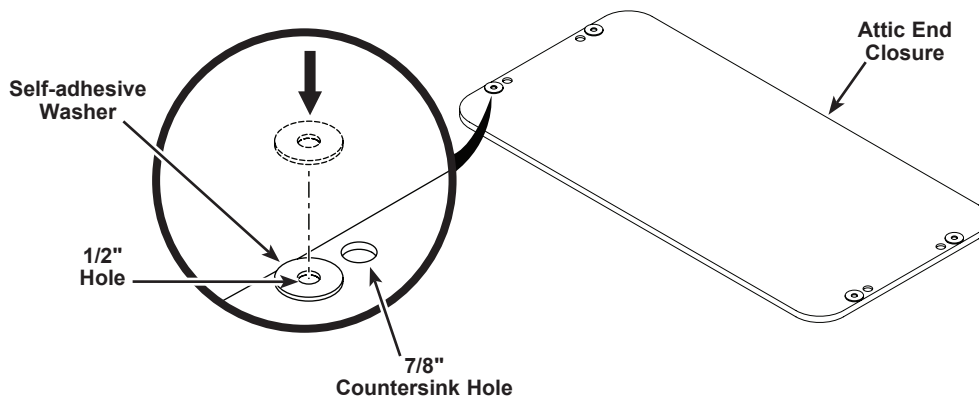

## Attic End Closure Installation (continued)

- Using a cordless drill and a 7/32" hex bit insert with a 9/16" combination wrench, remove the **upper** button head screw and acorn nut from each of the two attic **upper** front end panel brackets on the attic end frame. Save the acorn nuts and discard the button head screws.
- Remove the **lower** button head screw and acorn nut from each of the two attic **lower** front end panel brackets on the attic end frame. Save the acorn nuts and discard the button head screws.

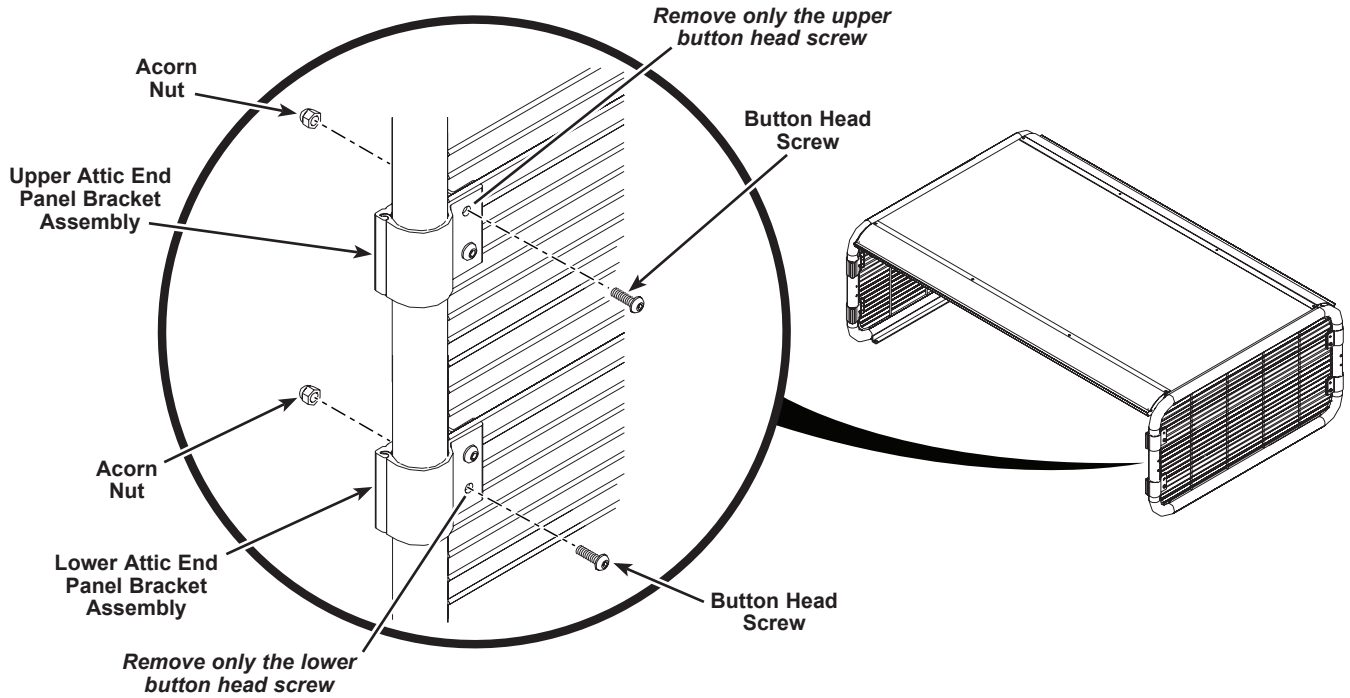

- Place the attic end closure against the attic end frame outer panel brackets.
  - Make sure that the washers applied in step 2 face the rear end frame.
  - Align the holes in the attic end closure to the holes in the outer brackets.
- Attach four 3/8-16 x 1-1/2" button head screws and the four acorn nuts (set aside in steps 3 and 4) as shown.

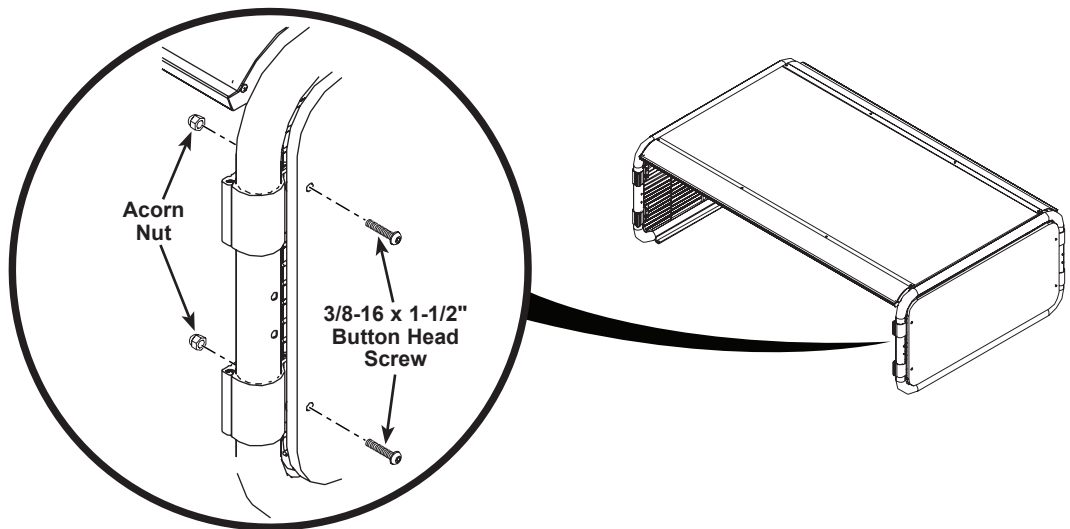

# Replacement Parts

## Cart End Closure

### NOTICE

When ordering, specify whether 32" (813 mm) or 48" (1219 mm) end closure.

Item	Description
1	Cart End Closure
2	1/2" Self-adhesive Washer
3	Dome Plug
4	3/8-16 x 1-1/2" Button Head Screw
5	3/8-16 x 1-3/4" Button Head Screw

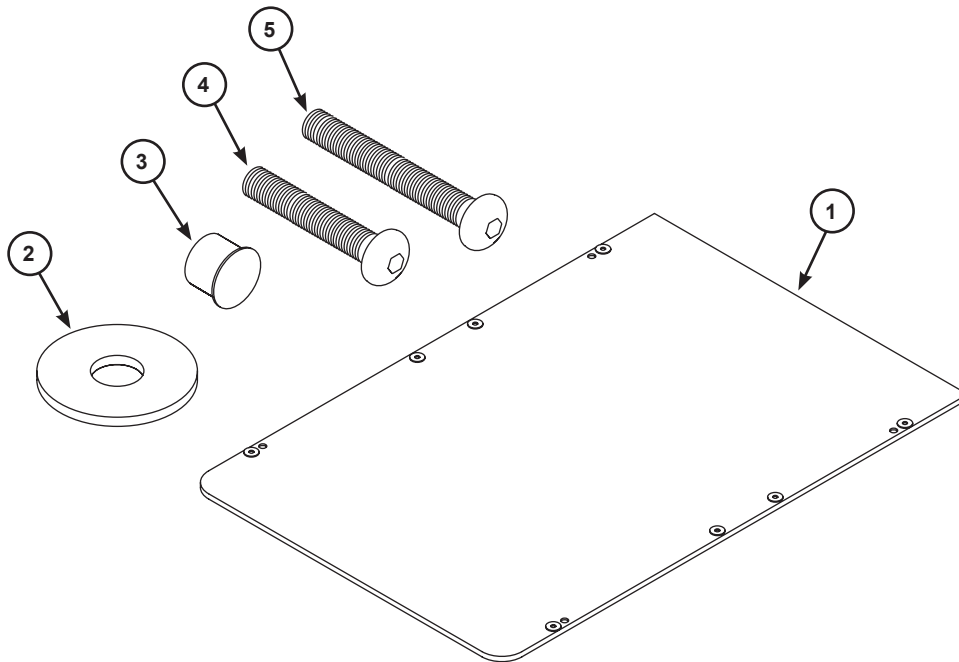

# Replacement Parts (continued)

## Attic End Closure

**NOTICE**  
When ordering, specify whether a tall or short attic end closure.

Item	Description
1	Attic End Closure
2	1/2" Self-adhesive Washer
3	3/8-16 x 1-1/2" Button Head Screw

